

## **ARCHITECTURAL ASSESSMENT - Web Links:**

### **Historic Status**

National Register of Historic Places

[www.iowahistory.org/historic-preservation/national-register-of-historic-places/properties-in-iowa.html](http://www.iowahistory.org/historic-preservation/national-register-of-historic-places/properties-in-iowa.html)

Iowa Survey of cultural resources

[www.iowahistory.org/historic-preservation/statewide-inventory-and-collections/index.html](http://www.iowahistory.org/historic-preservation/statewide-inventory-and-collections/index.html)

### **Seismic Hazard Map:**

<http://earthquake.usgs.gov/earthquakes/states/iowa/hazards.php>

### **Sanborn Maps**

[www.statelibraryofiowa.org/services/online-resources/resources/sanborn-login](http://www.statelibraryofiowa.org/services/online-resources/resources/sanborn-login)

### **Flood Insurance Rate Maps FIRM**

[www.fema.gov/hazard/map/flood.shtm](http://www.fema.gov/hazard/map/flood.shtm)

### **Environmental Assessment:**

Environmental Assessment Process

A guide to the Phase I Environmental Assessment

<http://www.enterprisefoundation.org/resources/dss/singlefam/sf&24&in&nc&ss&lg&rin&rnc&ucpsc18.htm>

## **Asbestos**

Iowa Division of Labor

[www.iowaworkforce.org/labor/asbestos.htm](http://www.iowaworkforce.org/labor/asbestos.htm)

## **Lead Paint**

US EPA

[www.epa.gov/lead/pubs/renovation.htm](http://www.epa.gov/lead/pubs/renovation.htm)

Iowa Dept. of Public Health

[www.epa.gov/lead/pubs/renovation.htm](http://www.epa.gov/lead/pubs/renovation.htm)

Lead Paint and Historic Buildings (free publication)

[www.illinoishistory.gov/PS/leadpaint.htm](http://www.illinoishistory.gov/PS/leadpaint.htm)

## **Building Codes**

Fire Ratings of Archaic Materials and Assemblies

[www.huduser.org/portal/publications/destech/fire.html](http://www.huduser.org/portal/publications/destech/fire.html)

Fire Code Product

Intumescent Paint - Fire Free 88 [www.firefree.com/allProducts.php](http://www.firefree.com/allProducts.php)

## **Eco Equation:**

National Trust Life Cycle Assessment (LCA) Study on Building Reuse

[www.preservationnation.org/issues/sustainability/green-lab/valuing-building-reuse.html](http://www.preservationnation.org/issues/sustainability/green-lab/valuing-building-reuse.html)

<http://tinyurl.com/nthpqvbr>

Parks Canada Study on Energy Efficient Renovation

<http://tinyurl.com/24eda2n>

## Natural Light and Air Requirements for Residential Use

(International Building Code 2000)

**General.** "Every space intended for human occupancy shall be provide with natural light by means of exterior glazed openings..." 1204.1

**Natural Light:** The minimum net glazed area shall not be less than 8 percent of the floor area of the room served. (1204.2)

**Adjoining Spaces** "a room is considered a portion of an adjoining room where one half of the common wall is open...and provides an area not less than 10% of the floor area of the interior room or 25 sq. ft., whichever is greater."

### Natural Ventilation 1202.4

**Natural ventilation of an occupied space** shall be through windows, doors, louvers, or other natural openings to the outdoors. 1202.4

**Ventilation Area Required:** The minimum vented area to the outdoors shall be **4 percent** of the floor area being ventilated. 1202.4.1

**Adjoining Spaces** (borrowed ventilation): The unobstructed opening to the adjoining room shall be at least 8 percent of the floor area of the room or space, but not less than **25 sq. ft.** The ventilation openings to the outdoors shall be based upon the total floor area being ventilated. 1202.4.1.1

Bathrooms ...shall be mechanically ventilated according to the Int. Mechanical Code. 1202.4.2.1

### Sample Light and Air Worksheet

Calculation showing maximum habitable room area using available windows

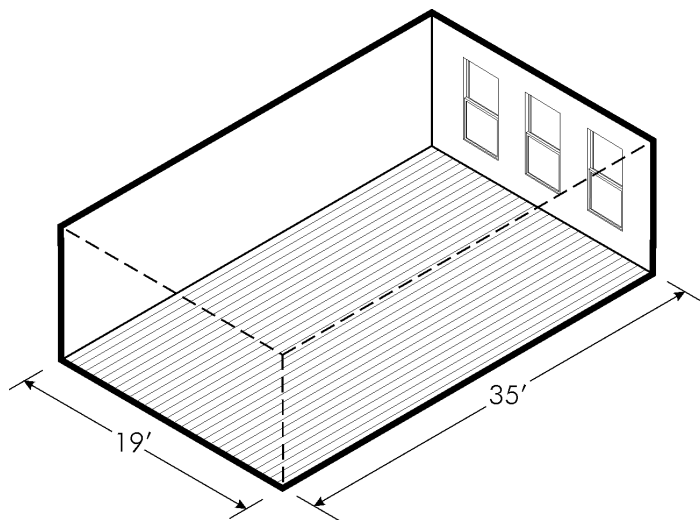

#### EXAMPLE

##### WINDOW AREA

3' X 6' = 18 sq. ft. per window  
x 3 windows  
54 sq. ft. of window glazing  
27 sq. ft. of vent opening

##### MAXIMUM ALLOWABLE ROOM SIZE

54 sq. ft. is 8 % of  
**675 sq. ft.**

Room is actually 19 x 35 = 665 sq. ft.  
 $665 \leq 675 \rightarrow$  the room is under the maximum allowable size.