



# Advocate Good Shepherd Hospital

450 West Highway 22 || Barrington, IL 60010 || T 847.381.0123 || [advocatehealth.com](http://advocatehealth.com)

---

April 18, 2019

Karen Senger, RN, BSN  
525 W. Jefferson Street, 4<sup>th</sup> Floor  
Springfield, IL 62761

Dear Ms. Senger:

This letter is to inform you that the Advocate Good Shepherd Hospital closed the eight-bed Pediatrics category of service as requested in the Certificate of Exemption, effective April 26, 2019.

Conversion of those beds to Medical Surgical category of service, as allowed in the certificate of exemption, is underway. Contact with the Design Standards division will be initiated to get those beds approved, according to code.

Once approved, please notify the Illinois Health Facilities and Services Review Board staff that the eight Medical Surgical beds are operational, so they can get those eight beds added to the 2019 bed inventory.

If you have further questions, you can contact me at 847-842-4004, Sonja Reece at 309-268-5482, or Trent Gordon at 847-842-4259.

Sincerely,

Karen Lambert  
President

Anderson Mikos Architects Ltd.

April 19, 2019

Henry Kowalenko  
Division Chief  
Design and Construction Section  
Division of Life Safety and Construction  
Illinois Department of Public Health  
525 W. Jefferson Street, 4<sup>th</sup> Floor  
Springfield, Illinois 62761-0001

Re: Advocate Good Shepherd Hospital – Barrington, Illinois  
Certificate of Exemption (COE) - E-067-18. Granted 1-15-2019  
Discontinuation of Pediatric Category of Service.

Henry,

Anderson Mikos Architects has been asked to review the facility to validate the space meets the requirements to convert Third Floor West of the Classic Tower pursuant to the COE in which Good Shepherd is requesting to convert 8 pediatric beds to 8 additional medical surgical beds.”

AMA has done a field survey of the building environment and have found the following:

- All patient rooms meet the IDPH requirements listed in the Administrative Code.
- We have highlighted the required support spaces required per the Administrative Code.
- All Exiting and Life Safety requirements meet the 2012 NFPA 101 code.

The hospital would like to begin using these beds as soon as possible and we hope that this information and attached drawings will provide you with the information required. If any other information is required, please let us know.

I trust the above will meet with your approval. If you have any questions or comments, please feel free to contact our office.

Regards,

Anderson Mikos Architects, Ltd.

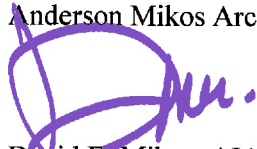

David E. Mikos, AIA  
Chairman and CEO

cc: Karen Mc Kenzie  
Paul Neff  
George Franceschina  
C. File, P. File

P:\Advocate\Good Shepherd\Ped Bed Conversion\Active\plot\LS1-1 Peds.dwg, 4/19/2019 1:48:37 PM



1 3RD FLOOR LIFE SAFETY PLAN  
SCALE: 1/32" = 1'-0"

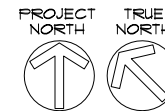

LIFE SAFETY LEGEND	
	SMOKE TIGHT PARTITION
	1-HR. SMOKE BARRIER
	1-HR. FIRE BARRIER
	1-HR. FIRE/SMOKE BARRIER
	2-HR. FIRE BARRIER
	2-HR. FIRE/SMOKE BARRIER
	3-HR. FIRE BARRIER
	SUITE BOUNDARY
	EXIT
	HAZARDOUS AREA

**Advocate**  
**Good Shepherd Hospital**  
Inspiring medicine. Changing lives.

Project **BED CONVERSION**  
**PEDIATRICS TO MEDICAL/ SURGERY BEDS**

Issue

**Anderson**  
**Mikos Architects Ltd.**  
"Architecture through Listening."  
Oak Brook Gateway  
1111 W. 22nd Street, Suite 315  
Oak Brook, Illinois 60523  
Tel. 630 - 573 - 5149  
Fax 630 - 573 - 5176

Drawn JG	Checked GF	Approved DEM	Date 04-19-2019	Scale AS NOTED	Job Number	Sheet
-------------	---------------	-----------------	--------------------	-------------------	------------	-------

P:\Advocate\Good Shepherd\Ped Bed Conversion\plot\A1-0 Peds.dwg, 4/19/2019 1:33:32 PM

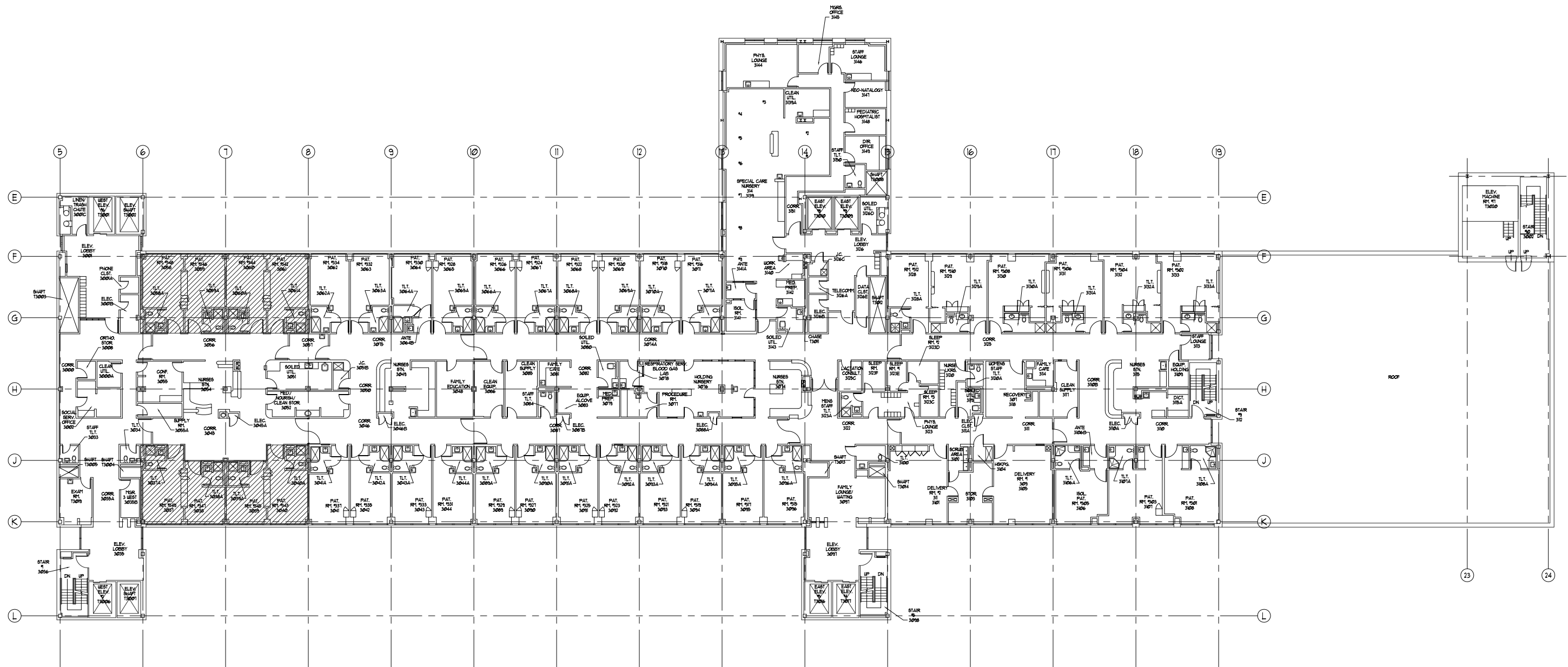

1 3RD FLOOR OVERALL PLAN  
SCALE: 1/32" = 1'-0"

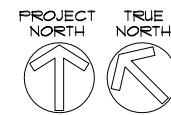

**Advocate**  
**Good Shepherd Hospital**  
Inspiring medicine. Changing lives.

Project

**BED CONVERSION  
PEDIATRICS TO MEDICAL/ SURGERY BEDS**

Issue

**Anderson  
Mikos Architects Ltd.**

"Architecture through Listening."

**Oak Brook Gateway**  
1111 W. 22nd Street, Suite 315  
Oak Brook, Illinois 60523  
Tel. 630 - 573 - 5149  
Fax 630 - 573 - 5176

Drawn JG	Checked GF	Approved DEM	Date 04-19-2019	Scale AS NOTED	Job Number	Sheet
-------------	---------------	-----------------	--------------------	-------------------	------------	-------

P:\Advocate\Good Shepherd\Ped Bed Conversion\Active\plot\A1-1 Ped.s.dwg, 4/19/2019 2:32:40 PM

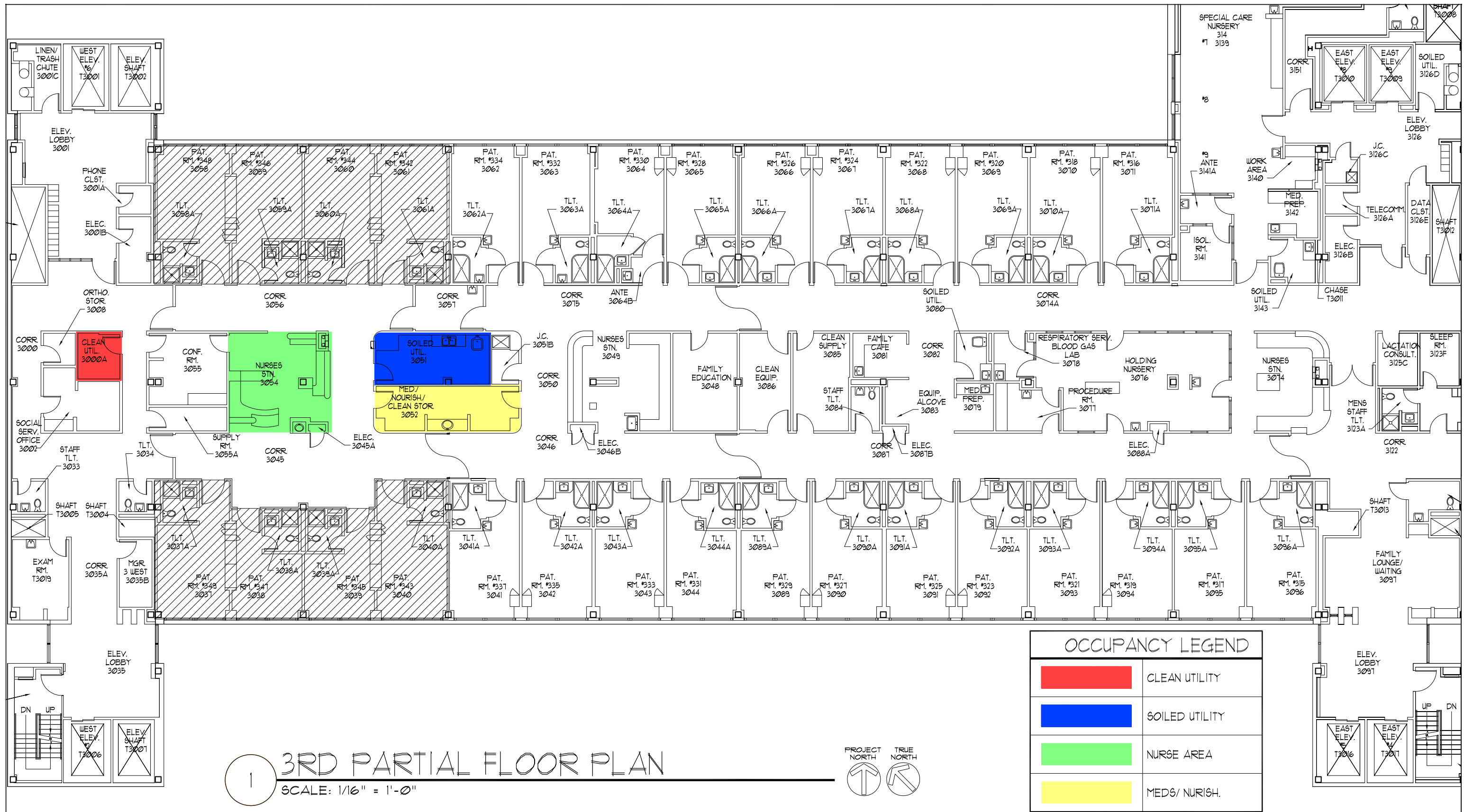

3RD PARTIAL FLOOR PLAN  
SCALE: 1/16" = 1'-0"

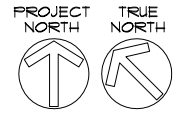

OCCUPANCY LEGEND	
<span style="display:inline-block; width:20px; height:10px; background-color:red;"></span>	CLEAN UTILITY
<span style="display:inline-block; width:20px; height:10px; background-color:blue;"></span>	SOILED UTILITY
<span style="display:inline-block; width:20px; height:10px; background-color:green;"></span>	NURSE AREA
<span style="display:inline-block; width:20px; height:10px; background-color:yellow;"></span>	MEDS/ NURISH.

**Advocate**  
**Good Shepherd Hospital**  
*Inspiring medicine. Changing lives.*

Project	<b>BED CONVERSION PEDIATRICS TO MEDICAL/ SURGERY BEDS</b>				
Issue					

**Anderson Mikos Architects Ltd.**  
*"Architecture through Listening"*  
Oak Brook Gateway  
1111 W. 22nd Street, Suite 315  
Oak Brook, Illinois 60523  
Tel. 630 - 573 - 5149  
Fax 630 - 573 - 5176

Drawn	Checked	Approved	Date	Scale	Job Number	Sheet
JG	GF	DEM	04-19-2019	AS NOTED		

## Neff, Paul

---

**From:** McKenzie, Karen <karen.mckenzie@aurora.org>  
**Sent:** Sunday, May 12, 2019 6:33 PM  
**To:** Neff, Paul  
**Subject:** Re: Shepherd 3 West Conversion - IDPH

That's great..  
Thanks

See next page.

Karen McKenzie  
Director Planning, Design & Construction  
Advocate Aurora Health

On May 11, 2019, at 3:32 PM, Neff, Paul <[paul.neff@advocatehealth.com](mailto:paul.neff@advocatehealth.com)> wrote:

FYI...

<image001.png>

**Paul Neff**

*Manager of Construction, Planning, Design and Construction*  
Advocate Sherman Hospital | Advocate Good Shepherd Hospital  
Sherman: 224.783.8081 (internal: 83-8081)  
Good Shepherd: 847-842-4122 (internal: 26-4122)  
M: 847.815.5872

<image002.jpg> <image003.jpg> <image004.png> <image005.jpg>

**From:** Neff, Paul  
**Sent:** Friday, May 10, 2019 5:10 PM  
**To:** Roesch, Mary <[mary.roesch@advocatehealth.com](mailto:mary.roesch@advocatehealth.com)>; George Franceschina <[gfranceschina@andersonmikos.com](mailto:gfranceschina@andersonmikos.com)>  
**Cc:** Rose, Lanndon <[lanndon.rose@advocatehealth.com](mailto:lanndon.rose@advocatehealth.com)>  
**Subject:** Re: Shepherd 3 West Conversion - IDPH

Great. Thanks George

Paul R. Neff  
Manager Construction  
Cell: 847-815-5872

---

**From:** Roesch, Mary <[mary.roesch@advocatehealth.com](mailto:mary.roesch@advocatehealth.com)>  
**Sent:** Friday, May 10, 2019 4:36 PM  
**To:** George Franceschina  
**Cc:** Neff, Paul; Rose, Lanndon  
**Subject:** Re: Shepherd 3 West Conversion - IDPH

That is good news thank you



Sent from my iPhone

On May 10, 2019, at 4:29 PM, George Franceschina <[gfranceschina@andersonmikos.com](mailto:gfranceschina@andersonmikos.com)> wrote:

Paul,  
Just got off the phone with Georgette at IDPH and the package we sent has been reviewed and approved.  
They will forward to the another department and they will send a letter to the hospital administrator.  
And that should be it!

Have a great weekend,  
George Franceschina  
**Anderson Mikos Architects, Ltd.**  
Oak Brook Gateway  
1111 22nd. Street, Suite 315  
Oak Brook, Illinois 60523  
Tel. (630) 573-5149 x3011 office  
(630) 244-0552 cell

**From:** Neff, Paul <[paul.neff@advocatehealth.com](mailto:paul.neff@advocatehealth.com)>  
**Sent:** Friday, May 10, 2019 8:23 AM  
**To:** George Franceschina <[gfranceschina@andersonmikos.com](mailto:gfranceschina@andersonmikos.com)>  
**Cc:** Rose, Lanndon <[lanndon.rose@advocatehealth.com](mailto:lanndon.rose@advocatehealth.com)>; Roesch, Mary <[mary.roesch@advocatehealth.com](mailto:mary.roesch@advocatehealth.com)>  
**Subject:** RE: Shepherd 3 West Conversion - IDPH

Thanks George. Let us know...  
Paul

<image001.png>  
**Paul Neff**  
*Manager of Construction, Planning, Design and Construction*  
Advocate Sherman Hospital | Advocate Good Shepherd Hospital  
Sherman: 224.783.8081 (internal: 83-8081)  
Good Shepherd: 847-842-4122 (internal: 26-4122)  
M: 847.815.5872  
<image002.jpg> <image003.jpg> <image004.png> <image005.jpg>

**From:** George Franceschina <[gfranceschina@andersonmikos.com](mailto:gfranceschina@andersonmikos.com)>  
**Sent:** Thursday, May 09, 2019 4:56 PM  
**To:** Neff, Paul <[paul.neff@advocatehealth.com](mailto:paul.neff@advocatehealth.com)>  
**Subject:** RE: Shepherd 3 West Conversion - IDPH

I will call down tomorrow for an update.

Thanks,  
George Franceschina

**Anderson Mikos Architects, Ltd.**

Oak Brook Gateway  
1111 22nd. Street, Suite 315  
Oak Brook, Illinois 60523  
Tel. (630) 573-5149 x3011 office  
(630) 244-0552 cell

---

**From:** Neff, Paul <[paul.neff@advocatehealth.com](mailto:paul.neff@advocatehealth.com)>  
**Sent:** Thursday, May 09, 2019 2:12 PM  
**To:** George Franceschina <[gfranceschina@andersonmikos.com](mailto:gfranceschina@andersonmikos.com)>  
**Subject:** Shepherd 3 West Conversion - IDPH

Any response from IDPH to your letter?

<image001.png>

**Paul Neff**

*Manager of Construction, Planning, Design and Construction*  
Advocate Sherman Hospital | Advocate Good Shepherd Hospital  
Sherman: 224.783.8081 (internal: 83-8081)  
Good Shepherd: 847-842-4122 (internal: 26-4122)  
M: 847.815.5872

<image002.jpg> <image003.jpg> <image004.png> <image005.jpg>

This e-mail, and any attachments thereto, is intended only for use by the addressee(s) named herein and may contain legally privileged and/or confidential information. If you are not the intended recipient of this e-mail (or the person responsible for delivering this document to the intended recipient), you are hereby notified that any dissemination, distribution, printing or copying of this e-mail, and any attachments thereto, is strictly prohibited. If you have received this e-mail in error, please respond to the individual sending the message and permanently delete the original and any copy of any e-mail and any printout thereof.